

**1. Table of Tape and Reel, Tube and Tray**  
编带卷盘，胶管托盘表格

Part Number 产品号	Package Description 封装	Quantity /Reel	Quantity /Rail*	Quantity /Tray	Reel Diameter	Carrier Tape Width	Carrier Tape Pitch
		每盘数量			卷盘直径	载带宽度	载带线距
MP####xH-Z	MSOP8/10 w/Exposed Pad	2500	50	N/A	13 in.	12 mm	8 mm
MP####xK-Z	MSOP8/10	2500	50	N/A	13 in.	12 mm	8 mm
MP####xP	PDIP8	N/A	50	N/A	N/A	N/A	N/A
MP####xP	PDIP16	N/A	25	N/A	N/A	N/A	N/A
MP####xP	PDIP8 w/Exposed Pad	N/A	50	N/A	N/A	N/A	N/A
MP####QD-Z	QFN 1.0x1.5	5000	N/A	N/A	13 in.	8 mm	4 mm
MP####xQG-Z	QFN 1.4x1.8	5000	N/A	N/A	13 in.	8 mm	4 mm
MP####QH-Z	QFN 1.5x2.0	5000	N/A	N/A	13 in.	8 mm	4 mm
MP####xQEU-Z	QFN1.5X2.5X0.55	5000	N/A	N/A	13 in.	8 mm	4 mm
MP####xQF-Z	QFN 1.6x1.2	5000	N/A	N/A	13 in.	8 mm	4 mm
MP####xG-Z	QFN 2x2	5000	N/A	N/A	13 in.	12 mm	8 mm
MP####xD-Z	QFN 2x3	5000	N/A	N/A	13 in.	12 mm	8 mm
MP####xQA-Z	QFN 2.2X2.6	5000	N/A	N/A	13 in.	12 mm	8 mm
MP####xRG-Z	QFN2.5X3.2	5000	N/A	N/A	13 in.	12 mm	8 mm
MP####xRH-Z	QFN2.5X3.5	5000	N/A	N/A	13 in.	12 mm	8 mm
MP####xD-Z	QFN 3x2	5000	N/A	N/A	13 in.	12 mm	8 mm
MP####xQ-Z	QFN 3x3	5000	N/A	N/A	13 in.	12 mm	8 mm
MP####xQBU-Z	QFN2.5X3.0X0.55	5000	N/A	N/A	13 in.	12 mm	8 mm
MP####xL-Z	QFN 3x4	5000	N/A	N/A	13 in.	12 mm	8 mm
MP####xQV-Z	QFN 3x5	5000	N/A	N/A	13 in.	12 mm	8 mm
MP####xRJ-Z	QFN 3x6	5000	N/A	N/A	13 in.	12 mm	8 mm
MP####xR-Z	QFN 4x4	5000	N/A	N/A	13 in.	12 mm	8 mm
MP####xV-Z	QFN 4x5	5000	N/A	N/A	13 in.	12 mm	8 mm
MP####xQW-Z	QFN 4x6	5000	N/A	N/A	13 in.	12 mm	8 mm
MP####x V-Z	QFN 5x4	5000	N/A	N/A	13 in.	12 mm	8 mm
MP####xU-Z	QFN 5x5	5000	N/A	N/A	13 in.	12 mm	8 mm
MP####xQJ-Z	QFN 5x6	5000	N/A	N/A	13 in.	12 mm	8 mm
MP####xQX-z	QFN 5x8	5000	N/A	N/A	13 in.	16 mm	8 mm
MP####xQK-Z	QFN 6x6	5000	N/A	N/A	13 in.	12 mm	8 mm
MP####xQN-Z	QFN 7x7	2500	N/A	N/A	13 in.	16 mm	12 mm
MP####xRK-Z	QFN 10x10	N/A	N/A	240	N/A	N/A	N/A
MP####x E-Z	SC70	3000	N/A	N/A	7 in.	8 mm	4 mm
MP####x S-Z	SOD123	3000	N/A	N/A	7 in.	8 mm	4 mm
MP####xTF-Z	SOT563	5000	N/A	N/A	7 in.	8 mm	4 mm
MP####xS-Z	SOIC8 (Narrow Body)	2500	100	N/A	13 in.	12 mm	8 mm
MP####xN-Z	SOIC8 w/Exposed Pad (Narrow Body)	2500	100	N/A	13 in.	12 mm	8 mm
MP####xS-Z	SOIC14 (Narrow Body)	2500	50	N/A	13 in.	16 mm	8 mm
MP####xS-Z	SOIC16 (Narrow Body)	2500	50	N/A	13 in.	16 mm	8 mm
MP####xN-Z	SOIC16 w/Exposed Pad (Narrow Body)	2500	50	N/A	13 in.	16 mm	8 mm
MP####xY-Z	SOIC18 (Wide Body)	1000	40	N/A	13 in.	24 mm	12 mm
MP####xY-Z	SOIC20 (Wide Body)	1000	37	N/A	13 in.	24 mm	12 mm
MP####xWR-Z	SOIC24 w/Heat Slug and Reverse Lead Bend	1000	31	N/A	13 in.	24 mm	12 mm
MP####xY-Z	SOIC28 (Wide Body)	1000	27	N/A	13 in.	24 mm	12 mm

**DO NOT COPY WITHOUT WRITTEN PERMISSION FROM MONOLITHIC POWER SYSTEMS**

**TITLE: TAPE AND REEL PACKAGE SPECIFICATION**  
编带卷盘产品封装规范

Part Number 产品号	Package Description 封装	Quantity /Reel 每盘数量	Quantity /Rail*	Quantity /Tray	Reel Diameter 卷盘直径	Carrier Tape Width 载带宽度	Carrier Tape Pitch 载带线距
MP####xT-Z	SOT23-3/5/6/8	3000	N/A	N/A	7 in.	8 mm	4 mm
MP####xJ-Z	TSOT23-4/5/6/8	3000	N/A	N/A	7 in.	8 mm	4 mm
MP####xJS-Z	TSOT23-6-SL	5000	N/A	N/A	13 in.	12 mm	8 mm
MP####xE-Z	SC70-5	3000	N/A	N/A	7 in.	8 mm	4 mm
MP####xM-Z	TSSOP8	2500	100	N/A	13 in.	12 mm	8 mm
MP####xM-Z	TSSOP14/16	2500	96	N/A	13 in.	16 mm	8 mm
MP####xF-Z	TSSOP16 w/Exposed Pad	2500	96	N/A	13 in.	16 mm	8 mm
MP####xM-Z	TSSOP20	2500	75	N/A	13 in.	16 mm	8 mm
MP####xF-Z	TSSOP20 w/Exposed Pad	2500	75	N/A	13 in.	16 mm	8 mm
MP####xM-Z	TSSOP28	2500	50	N/A	13 in.	16 mm	8 mm
MP####xF-Z	TSSOP28 w/Exposed Pad	2500	50	N/A	13 in.	16 mm	8 mm
MP####xFR-Z	TSSOP38 w/Exposed Pad, Reverse Lead Bend	2500	31	N/A	13 in.	16 mm	8 mm
MP####xZ	TO220	N/A	50	N/A	N/A	N/A	N/A
MP####xQN	TQFP7X7-1.0	N/A	N/A	250	N/A	N/A	N/A
MP####xC-Z	WLCSP 0.8x0.8	3000	N/A	N/A	7in.	8 mm	4 mm
MP####xC-Z	WLCSP 1.0x1.5	3000	N/A	N/A	7in.	8 mm	4 mm
MP####xC-Z	WLCSP 1.5x1.5	3000	N/A	N/A	7in.	8 mm	4 mm
MP####xC-Z	WLCSP 1.6x2.0	3000	N/A	N/A	7 in	8 mm	4 mm
MP####xC-Z	WLCSP 0.8x1.6	3000	N/A	N/A	7 in	8 mm	4 mm
MPM####xQB-Z	MPM QFN2.5x3.0x0.9	5000	N/A	N/A	13 in.	12 mm	8 mm
MPM####xQV-Z	MPM QFN3.0x5.0x1.6	2500	N/A	N/A	13 in.	12 mm	8 mm
MPM####xG-Z	MPM QFN2x2x1.6	2500	N/A	N/A	13 in.	12 mm	8 mm
MPM####xR-Z	MPM QFN4.0x4.0x1.6	2500	N/A	N/A	13 in.	12 mm	8 mm
MPM####xRU	MPM QFN12x15x4	N/A	N/A	136	N/A	N/A	N/A
MPM####xRE	MPM QFN12x12x4	N/A	N/A	168	N/A	N/A	N/A
MPM####xLD	MPM LGA10x10x4.2	N/A	N/A	168	N/A	N/A	N/A
MPM####xLE-Z	MPM LGA 12x12-4.2mm	N/A	N/A	168	N/A	N/A	N/A

\* N/A indicates "not available" in rails. For 500 piece tape & reel prototype quantities, see factory. (Order code for 500 piece partial reel is "-P", tape & reel dimensions same as full reel.)

Rail 栏的N/A 表示该产品不适合用Tube 出货。对于每卷500 个的编带&卷盘，参见工厂规范。（针对500每卷的订单编号，应带后缀-P，外观尺寸与整卷出货一致）

**DO NOT COPY WITHOUT WRITTEN PERMISSION FROM MONOLITHIC POWER SYSTEMS**

**Pin 1 Orientation by Package Type**

- SOIC, TSSOP and MSOP

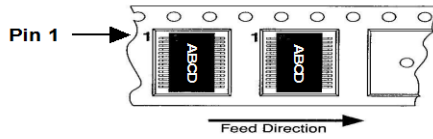

- QFN Packages

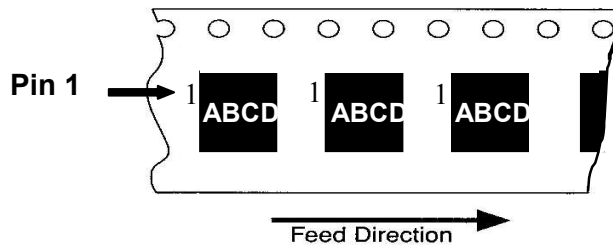

- SOT23, TSOT23 & SC70 Packages

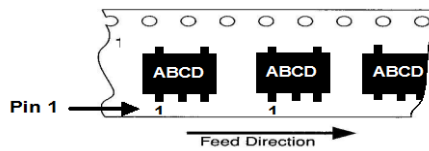

- Pin1 Orientation in Tray

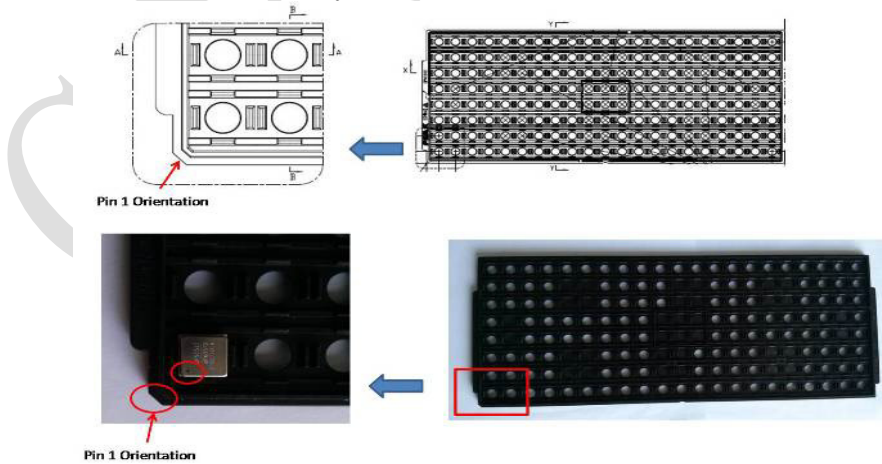

DO NOT COPY WITHOUT WRITTEN PERMISSION FROM MONOLITHIC POWER SYSTEMS

## 2. Partial Reels 非完整卷盘

2.1. MPS may offer partial reel with only 500 units in the reel.

MPS 会提供只含 500 颗产品的非完整卷盘。

2.2. The reel size of partial reel will be the same as standard Tape and Reel, as exhibited on the table in section 3.0. However, the reel size of partial reel of QFN packages shipped out from MPS/USA might be 7”.

非完整卷盘的尺寸与 3.0 表中的标准的 T&R 一样，然而，从 MPS/USA 出货的 QFN 封装的非完整卷盘的尺寸可能是 7”。

CONTROLLED